

100W DALI-2 Dimmable Driver

DIMDA2P-IP10024

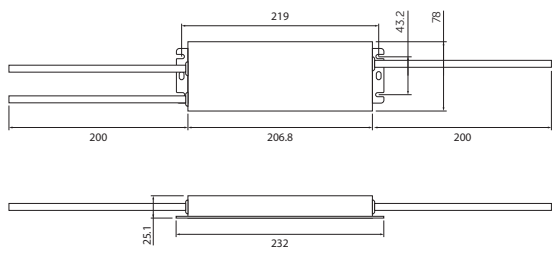

COM



IP66

DC
24V

Product Reference: **DIMDA2P-IP10024**

The fossLED DALI-2 Dimmable Drivers are compatible with DALI and DALI-2 dimming systems with a dimming capacity of 1 - 100%; for further information please contact us on 0203 198 1908.

Technical Specification:

Output	Output Power DC Voltage Dimming Capacity Voltage Tolerance Rated Current	100W 24v 1-100% ±0.5% 4.17A
Input	Input Voltage Range AC Frequency Power Factor Efficiency AC Current Leakage Current Inrush Current	100 - 277VAC 47 - 63 Hz >0.96 >87% 1.05A <0.50mA/220VAC 59A (Twidth=210µs 230VAC)
Environment	Working Temp Relative Humidity Vibration	-40°C - +80°C 20 - 95% 10 - 500Hz/ 5G, 10 minutes
Safety & EMC	Withstand Voltage EMI Safety EMC Emission EMC Immunity	I/P-O/P:3.75KVAC I/P-FG:1.5KVAC O/P-FG:0.5KVAC EN55015 Class B EN61347-1, EN61347-2-13, EN62493 EN55015, EN61000-3-2, EN61000-3-3 (≥60% load) EN61000-4-2,3,4,5,6,11, EN61547
Weight Size	Kilograms Dimensions (mm)	0.83 Kg 232 x 78 x 25.1 mm